



General Description

The "Minimax" Pump range is specifically designed for injecting chemical, antifreeze and corrosion inhibitors; these injectors are single acting air/gas driven, positive displacement pumps, which operate at supply pressure ranging from 15 to 125 psi; all series are powered by a piston motor (available upon request with spring return for the CL version) and the supply pressure is cycled only on one side of the power piston before being released.

A wide regulation of flow rates can be achieved by means of operating the speed control valve available for the DSsp version, while the exhaust port can be piped when gas is the power source.

The construction is aimed to provide solutions, which are corrosion resistant and complete specific units can be designed and manufactured to suit the specific application need and to meet customer's requirements.

Typical Applications

HydroPneumatic Minimax Pumps are typically the perfect solution for:

- Chemical Injection and Metering Systems as well as portable test unit

Features

- Comprehensive range suitable for the construction of packaged systems and skids to meet the customer's precise design requirements and specifications
- Available in 9 models, with piston spring return - CL model, and with speed control valve - DSsp version
- Suitable for extreme service
- Intrinsically safe
- Reliable
- Easy to install
- Low gas consumption
- Pressures up to more than 22000 PSI (1500 bar)



Plus

- Available in other sizes and series

Performance Data (supply pressure 8,6 BAR / 120 PSI)

Model Number	Gas / Fluid Pressure Ratio	Volume Cm ³ /Stroke	Max. Discharge Pressure		Max. Volume / Day			
			PSI	BAR	Intermittent (50 strokes / min.)		Continuous (35 strokes / min.)	
					Gals	Lts	Gals	Lts
30-08	180/1	1.5	22480	1550	29	108	20	76
30-10	115/1	2.3	14360	990	44	165	31	116
30-12	80/1	3.4	10000	690	65	245	45	171
30-14	58/1	4.6	7250	500	87	331	61	232
30-16	45/1	6.0	5650	390	114	432	80	302
30-18	36/1	7.6	4500	310	145	547	101	383
30-20	29/1	9.4	3620	250	179	677	125	474
30-22	24/1	11.4	2970	205	217	821	152	575
30-24	20/1	13.5	2460	170	257	972	180	680





Main components & details

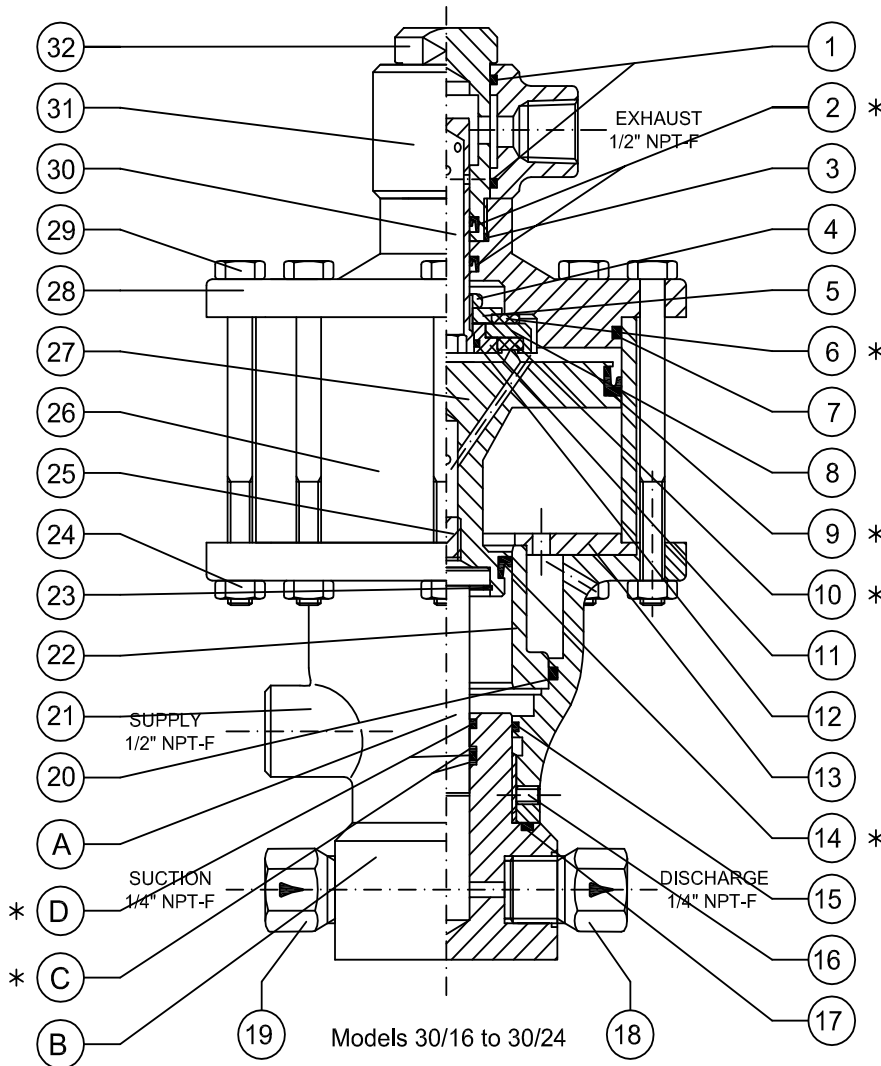

Models 30/16 to 30/24

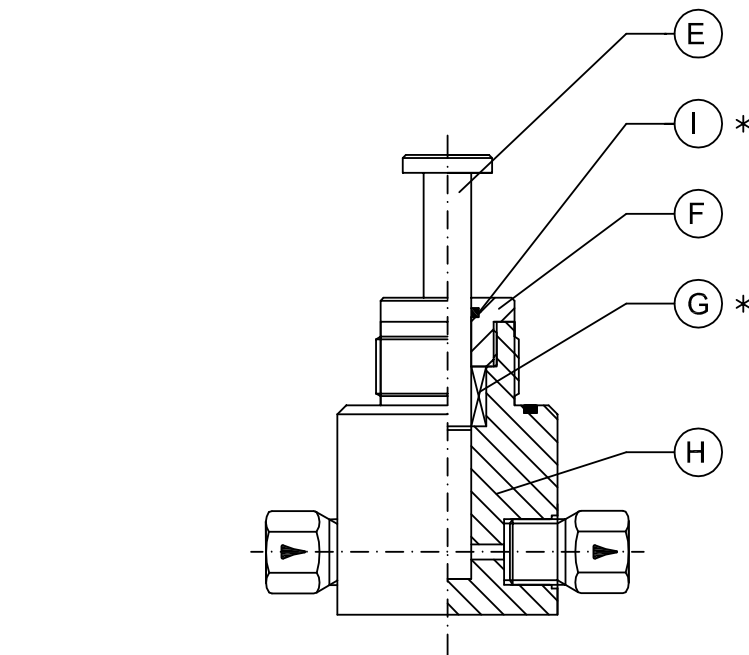

Models 30/8 to 30/14

Power end Items

Number	Item	Q.ty
1	"O" Ring	2
* 2	Stroke Stem Seal	2
3	"O" Ring	1
4	Nut	1
5	Dump Retainer Ring	1
* 6	Dump Ring	1
7	"O" Ring	1
8	Actuating Valve Inner Ring	1
* 9	Piston Seal	1
* 10	Soft Seal	1
11	Actuating Valve Inner Ring	1
12	"O" Ring	1
13	Cylinder Plate	1
* 14	Piston Seal	1
15	"O" Ring	1
16	Set Screw	11
17	"O" Ring	1
18	Discharge Check Valve	1
19	Suction Check Valve	1
20	"O" Ring	1
21	Lower Body	1
22	Lower Cylinder	1
23	Snap Ring	1
24	Nut	8
25	Choke Screw	1
26	Upper Cylinder	1
27	Pneumatic Piston	1
28	Cylinder Head	1
29	Bolt	8
30	Stroke Stem	1
31	Exhaust Stem	1
32	Stroke Stem Housing	1

* Suggested spare parts

Fluid end Items

Number	Item
A	Hydraulic Piston
B	Body
* C	"BK" Ring
* D	"O" Ring
E	Hydraulic Piston
F	Packing Retainer
* G	Packing
H	Body
* I	O" Ring

* Suggested spare parts

